



## TPO ROOFING SYSTEMS



# ARDEX GREEN ROOFING SYSTEMS

## NOBODY COVERS YOU GREENER

### ARDEX TPO GREEN ROOFS

Putting a garden on your roof is a great way to make better use of city space, protect the environment and save money in the long term. These vegetative or garden roofs – a roof area of plantings installed above a waterproofing membrane – have become very successful on rooftops around the world.

The benefits of the combination of a ARDEX TPO membrane with a green roof system are numerous:

- Increased life expectancy of the roof
- Added value and aesthetics
- Lower energy costs
- Easy installation and maintenance
- Improved air quality
- Reduction of the urban heat-island effect
- Storm water management
- Extra soundproofing and insulation
- A natural habitat for plants and birds





Images courtesy of Firestone Building Products

ARDEX WPM 615 TPO is an ideal membrane for combination with extensive green roof systems, using lightweight and low maintenance sedum vegetation. This lightweight, scrim-reinforced and heat-weldable membrane has successfully passed the FLL test for root penetration and can therefore provide dependable performance in a demanding roofing environment.

### RECOMMENDED BUILD-UP FOR EXTENSIVE ROOFS\*

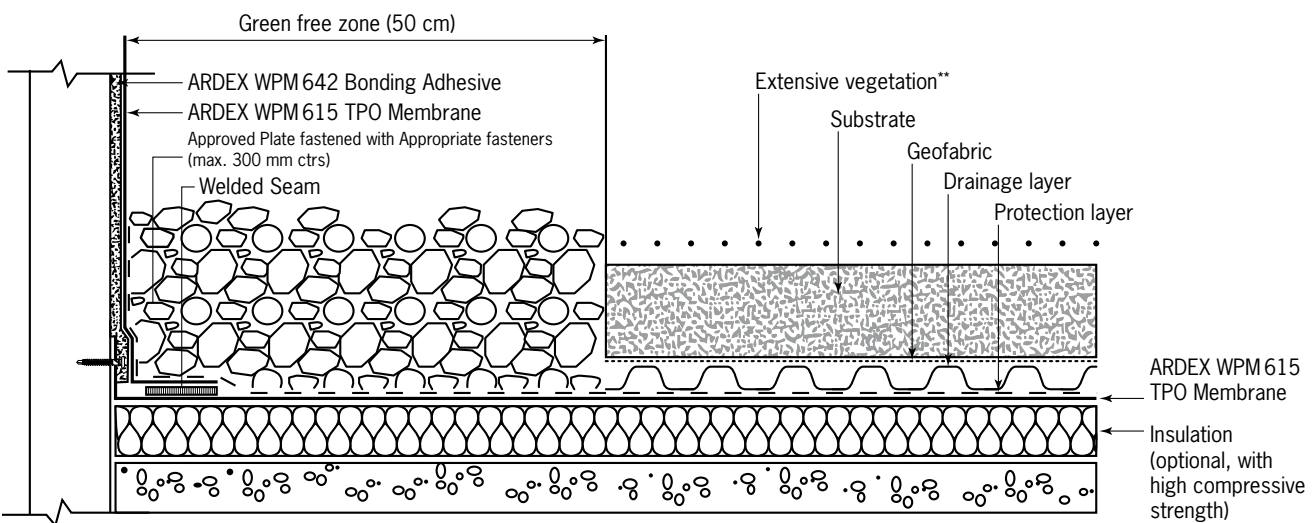

### ARDEX WPM 615 TPO – PRODUCT INFORMATION

Product Line		
Membrane	Size	Unit
Thickness	1.5	mm
Width	2.0	m
Length	30.5	m
Weight	1.5	kg/m <sup>2</sup>

Fire properties		
Property	Standard	Classification
Reaction to fire	EN 13501-1	E
External fire performance	EN 13505-5	B <sub>ROOF</sub> (t1)

\* For other types of green roofs, please consult ARDEX Technical Department.  
 \*\* A shallow planting system (less than 10 cm in depth) ideally suited for areas that will receive little maintenance. Recommended plants include sedums, herbs and grasses.

For latest updates and additional info please consult our website at [www.ardex.com](http://www.ardex.com). Testing results and/or copies of Approval Documents for above mentioned membranes are available upon request.

#### ARDEX Australia Pty Ltd

Technical Services Toll Free: 1800 224 070

New South Wales	Ph (02) 9851 9100	Fax (02) 9838 7970
Queensland	Ph (07) 3817 6000	Fax (07) 3881 3188
Victoria/Tasmania	Ph (03) 8339 3100	Fax (03) 9308 9332
South Australia	Ph (08) 8406 2500	Fax (08) 8345 3207
Western Australia	Ph (08) 9256 8600	Fax (08) 9455 1227

[www.ardex.com](http://www.ardex.com)

Physical Properties				
Property	Test Method	Declared value	Unit	
Watertightness	EN 1928 (B)	pass		
Tensile strength (L/T)	EN 12311-2 (A)	≥ 800	N/50 mm	
Elongation	EN 12311-2 (A)	≥ 20	%	
Resistance to static load – soft substrate	EN 12730 (A)	≥ 25	kg	
Resistance to static load – hard substrate	EN 12730 (B)	≥ 25	kg	
Resistance to impact – soft substrate	EN 12691 (A)	≥ 2000	mm	
Resistance to impact – soft substrate	EN 12691 (B)	≥ 800	mm	
Tear resistance	EN 12310-2	≥ 400	N	
Joint peel resistance	EN 12316-2	≥ 100	N/50mm	
Foldability at low temperature	EN 495-5	≤ -45	N/50mm	
UV exposure	EN 1297	pass	°C	
Resistance to root penetration	EN 13948	pass		

#### ARDEX New Zealand Ltd

Technical Services Toll Free: 0800 227 339

Auckland	Ph (09) 5800 005	Fax (09) 2967 689
Wellington	Ph (04) 5685 949	Fax (04) 5686 376
Christchurch	Ph (03) 3736 900	Fax (03) 3849 779